

±45,234 Sq. Ft. For Lease

13170 Lochridge Blvd, Units A - G • Covington, GA 30014



PROPERTY FEATURES:

- ±6,474 - 45,234 sq. ft. available in Newton County, GA
- 22' Clear ceiling height
- 21 Dock high doors (9' x 10') and 3 Drive-in doors (12' x 14')
- 40' x 40' column spacing
- ±2,600 sq. ft. of new office space (additional office is BTS)
- Sprinkler system (0.3 GPM over the most remote 3,000 SF)
- 120' Truck court (50' concrete apron with 70' heavy duty asphalt)
- Suitable for manufacturing, warehousing or distribution
- Located just off of Hwy 142 in Lochridge Industrial Park, only 0.5 miles south of I-20, Exit 93
- Convenient to Hwy 278 and the new Baxter International facility
- City of Covington provides water, sewer, electricity and gas

Gene Baldwin

gbaldwin@ipgproperties.com

706.474.2835 (cell)

770.536.6555

Industrial Properties Group, Inc.

PO Box 461

Madison, GA 30650

www.ipgproperties.com



Local Knowledge • Global Networks

Information contained herein is from sources believed to be reliable. No independent investigation of the property or information contained herein has been made, and no representation is made as to the accuracy thereof. Properties subject to prior sale, withdrawal and other sales or rental conditions. Terms subject to errors, omissions and change without notice.

SITE PLAN

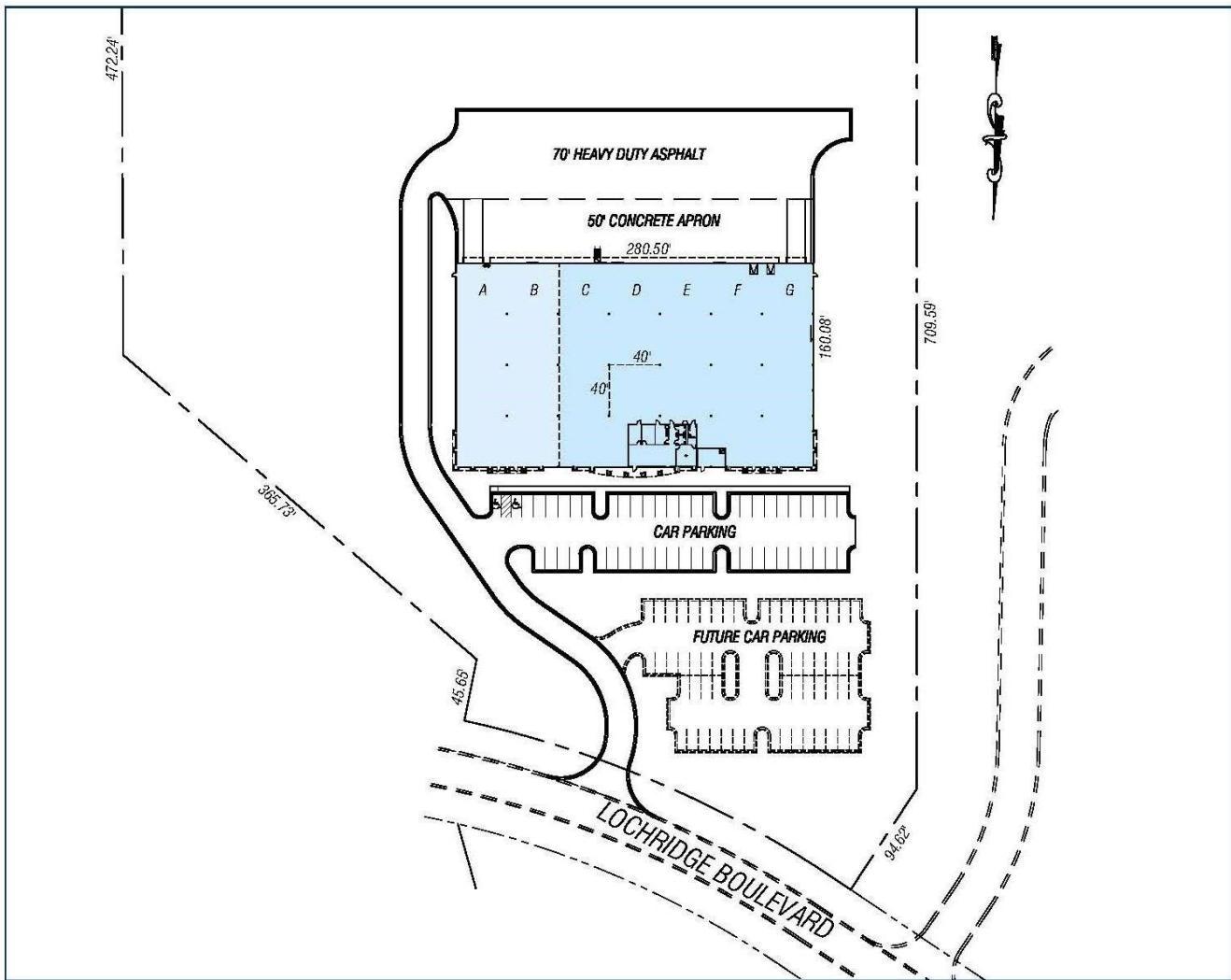

13170 Lochridge Boulevard, Units A - G



Local Knowledge • Global Networks

Industrial Properties Group, Inc.

770.536.6555

www.ipgproperties.com

Gene Baldwin

gbaldwin@ipgproperties.com