



14481 Lochridge Blvd

Covington, GA 30014



For Lease
±121,418 SF
Newton County



Industrial Properties Group
PO Box 364, Gainesville, GA 30503
770.536.6555
www.ipgproperties.com

Gene Baldwin
gbaldwin@ipgproperties.com
706.474.2835 (cell)
770.536.6555 x 223 (office)

PROPERTY OVERVIEW

14481 Lochridge Blvd | Covington, GA 30014



For Lease
±121,418 SF
Newton County

PROPERTY FEATURES:

±121,418 sq. ft. industrial space for lease

6 dock high doors

2 drive-in doors

25' clear height

50' x 50' column spacing

Competitive lease rates

Only 0.25 miles from I-20 (Exit 93) and Hwy 142

BUILDING LAYOUT

14481 Lochridge Blvd | Covington, GA 30014

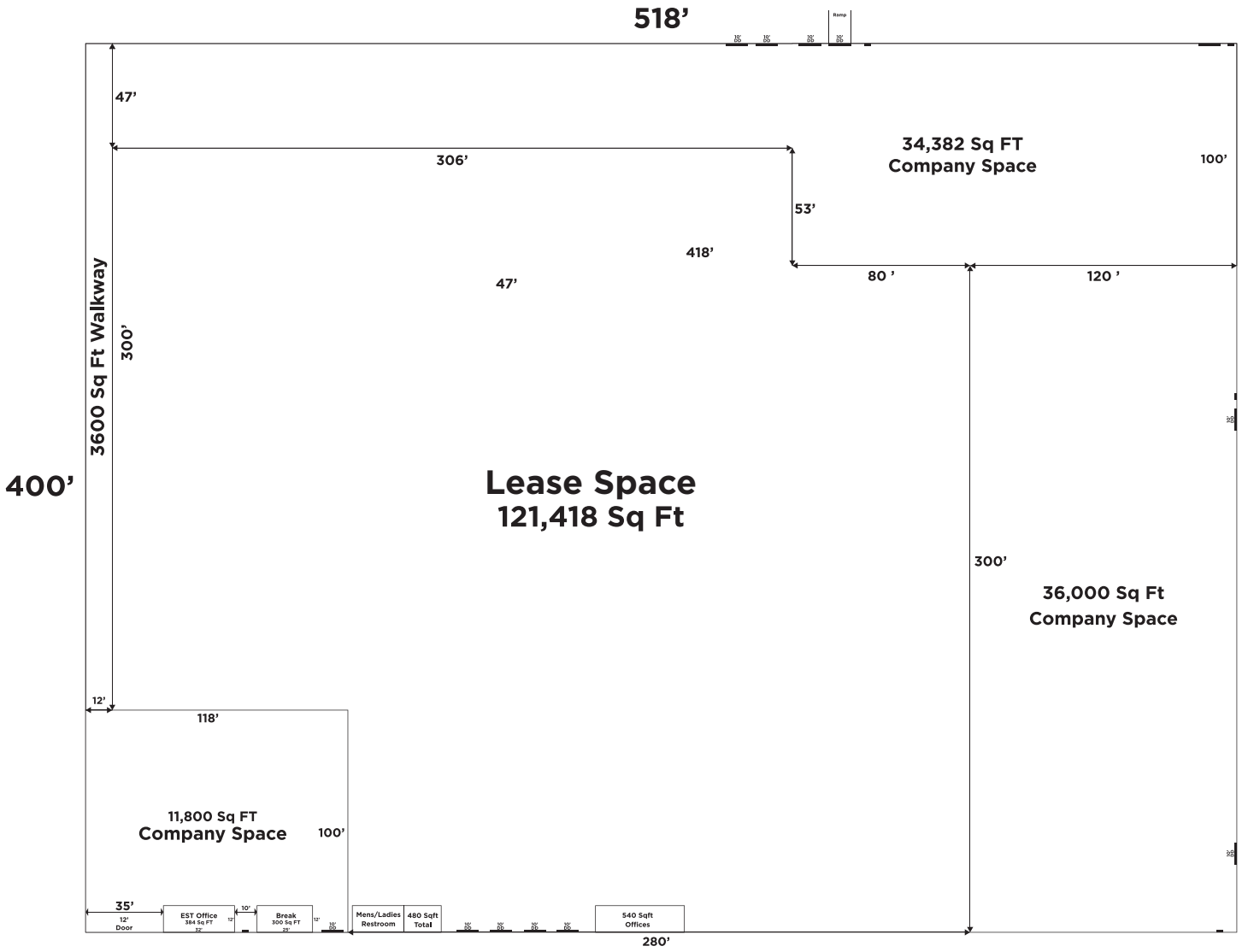

Gene Baldwin

gbaldwin@ipgproperties.com

706.474.2835 (cell)

770.536.6555 x 223 (office)



LOCATION

14481 Lochridge Blvd | Covington, GA 30014

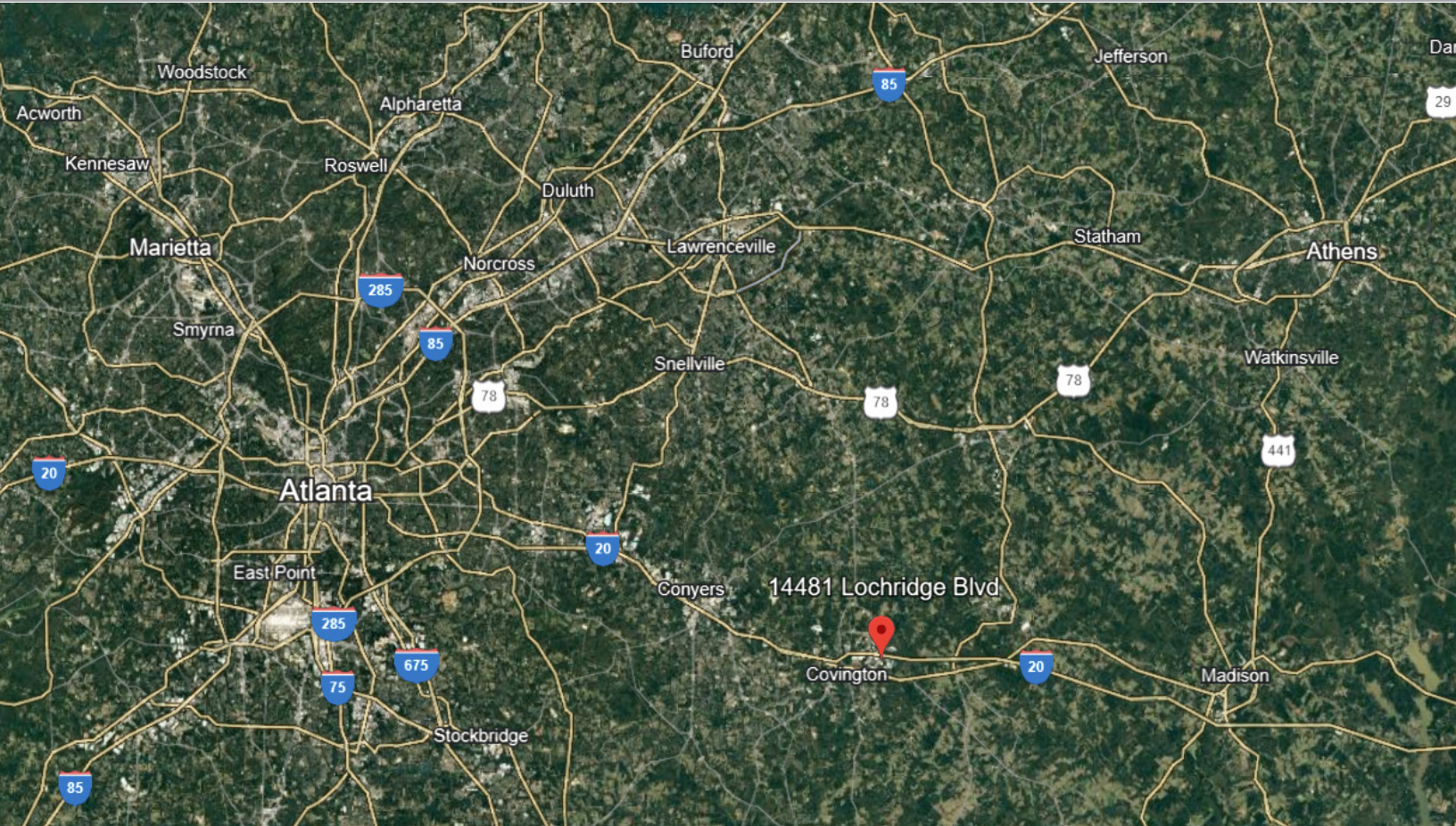

DISTANCES:

I-20, Exit 93:	±0.25 miles	Downtown Atlanta:	±36 miles
I-285:	±27 miles	Hartsfield Jackson Int'l Airport:	±36 miles
I-85:	±39 miles	Greenville, SC:	±142 miles
Downtown Covington:	±2.5 miles	Port of Savannah:	±230 miles

Gene Baldwin

gbaldwin@ipgproperties.com

706.474.2835 (cell)

770.536.6555 x 223 (office)

