



# 200 Cherry Hill Rd

Monroe, GA 30656



**For Lease**  
**±129,380 SF**  
Walton County



**IPG Properties**  
PO Box 364, Gainesville, GA 30503  
770.536.6555  
[www.ipgproperties.com](http://www.ipgproperties.com)

**Drew C. Addison, SIOR**  
daddison@ipgproperties.com  
678.316.2409 (cell)  
770.536.6555 x 232 (office)

**Floyd H. Baldwin, SIOR**  
fbaldwin@ipgproperties.com  
770.287.5288 (cell)  
770.536.6555 x 222 (office)

**Palmer H. Loggins**  
ploggins@ipgproperties.com  
770.561.3751 (cell)  
770.536.6555 x 234 (office)

# PROPERTY OVERVIEW

200 Cherry Hill Road, Monroe, GA 30656



**For Lease**  
**±129,380 SF**

Walton County

## PROPERTY FEATURES:

±129,380 total sq. ft. for lease

9 dock high doors

1 drive-in door

14' - 20' ceiling height

40' x 40' column spacing

Outside storage

Employee breakroom

Frontage on Hwy 78

Easy access to future Monroe bypass

# FLOOR PLAN & PHOTOS

200 Cherry Hill Road, Monroe, GA 30656

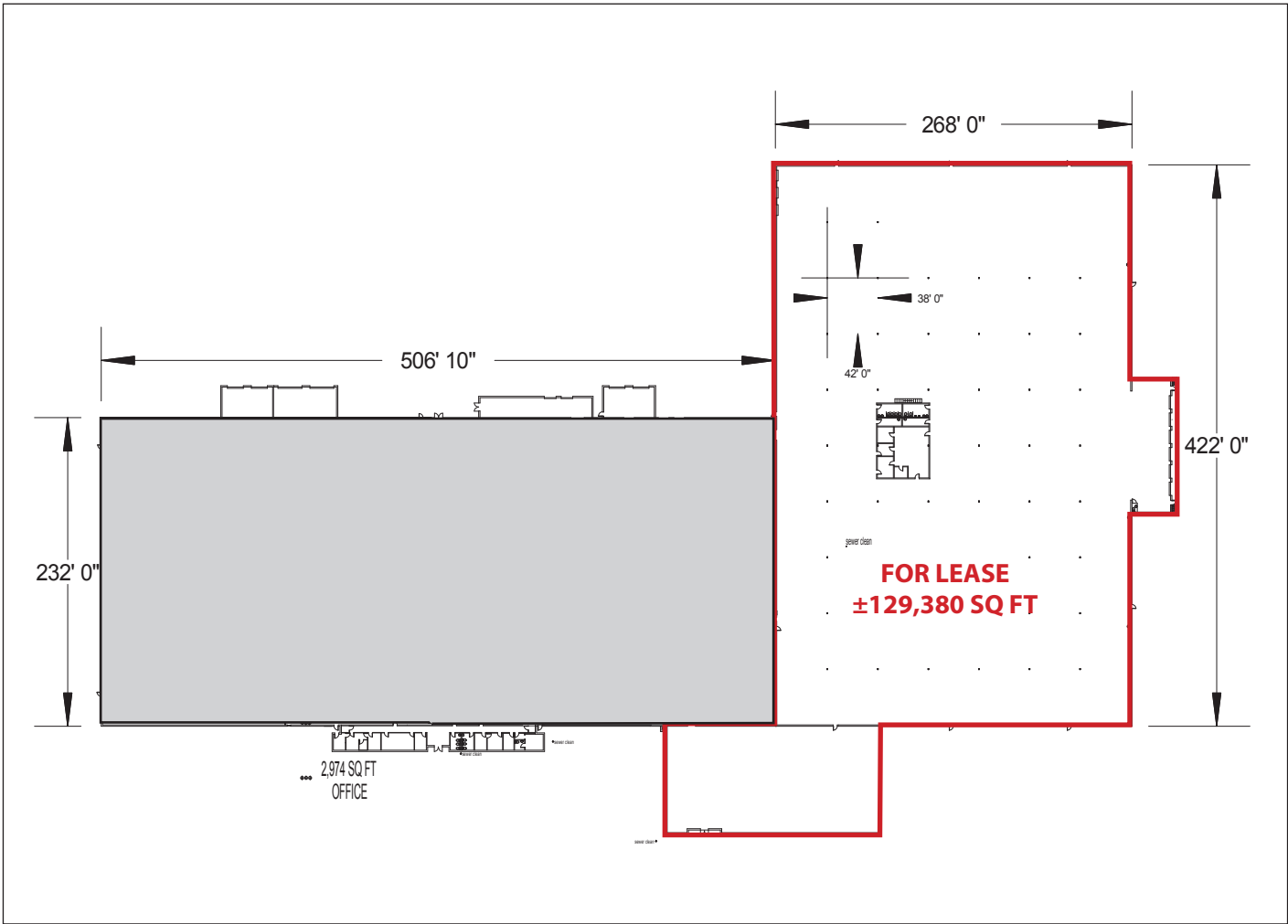

**Drew C. Addison, SIOR**  
daddison@ipgproperties.com  
678.316.2409 (cell)  
770.536.6555 x 232 (office)

**Floyd H. Baldwin, SIOR**  
fbaldwin@ipgproperties.com  
770.287.5288 (cell)  
770.536.6555 x 222 (office)

**Palmer H. Loggins**  
ploggins@ipgproperties.com  
770.561.3751 (cell)  
770.536.6555 x 234 (office)



# LOCATION

200 Cherry Hill Road, Monroe, GA 30656

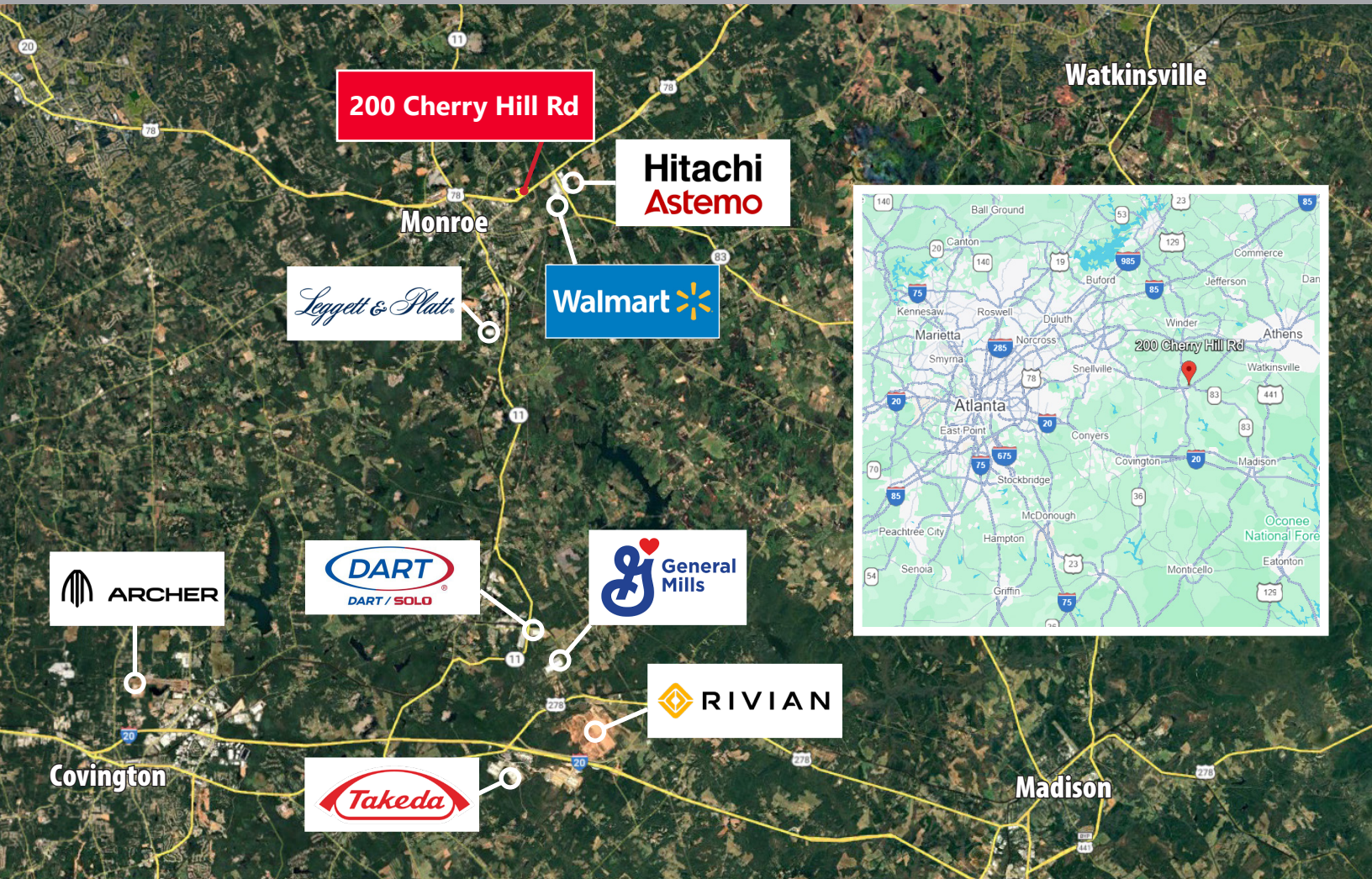

## DISTANCES:

Hwy 78:	±0.2 miles	Downtown Atlanta:	±43 miles
Hwy 129:	±11 miles	Rivian Plant:	±22 miles
I-20:	±18 miles	Hartsfield Jackson Int'l Airport:	±53 miles
I-85 N:	±24 miles	Gainesville Inland Port:	±50 miles
I-285 E:	±33 miles	Port of Savannah:	±230 miles
I-75 S:	±55 miles	Greenville, SC:	±118 miles

**Drew C. Addison, SIOR**  
 daddison@ipgproperties.com  
 678.316.2409 (cell)  
 770.536.6555 x 232 (office)

**Floyd H. Baldwin, SIOR**  
 fbaldwin@ipgproperties.com  
 770.287.5288 (cell)  
 770.536.6555 x 222 (office)

**Palmer H. Loggins**  
 ploggins@ipgproperties.com  
 770.561.3751 (cell)  
 770.536.6555 x 234 (office)

