



200 Cherry Hill Rd

Monroe, GA 30656



For Lease
±129,380 SF
Walton County



IPG Properties
PO Box 364, Gainesville, GA 30503
770.536.6555
www.ipgproperties.com

Drew C. Addison, SIOR
daddison@ipgproperties.com
678.316.2409 (cell)
770.536.6555 x 232 (office)

Floyd H. Baldwin, SIOR
fbaldwin@ipgproperties.com
770.287.5288 (cell)
770.536.6555 x 222 (office)

Palmer H. Loggins
ploggins@ipgproperties.com
770.561.3751 (cell)
770.536.6555 x 234 (office)

PROPERTY OVERVIEW

200 Cherry Hill Road, Monroe, GA 30656



For Lease
±129,380 SF

Walton County

PROPERTY FEATURES:

±129,380 total sq. ft. for lease

9 dock high doors

1 drive-in door

14' - 20' ceiling height

40' x 40' column spacing

Outside storage

Employee breakroom

Frontage on Hwy 78

Easy access to future Monroe bypass

FLOOR PLAN & PHOTOS

200 Cherry Hill Road, Monroe, GA 30656

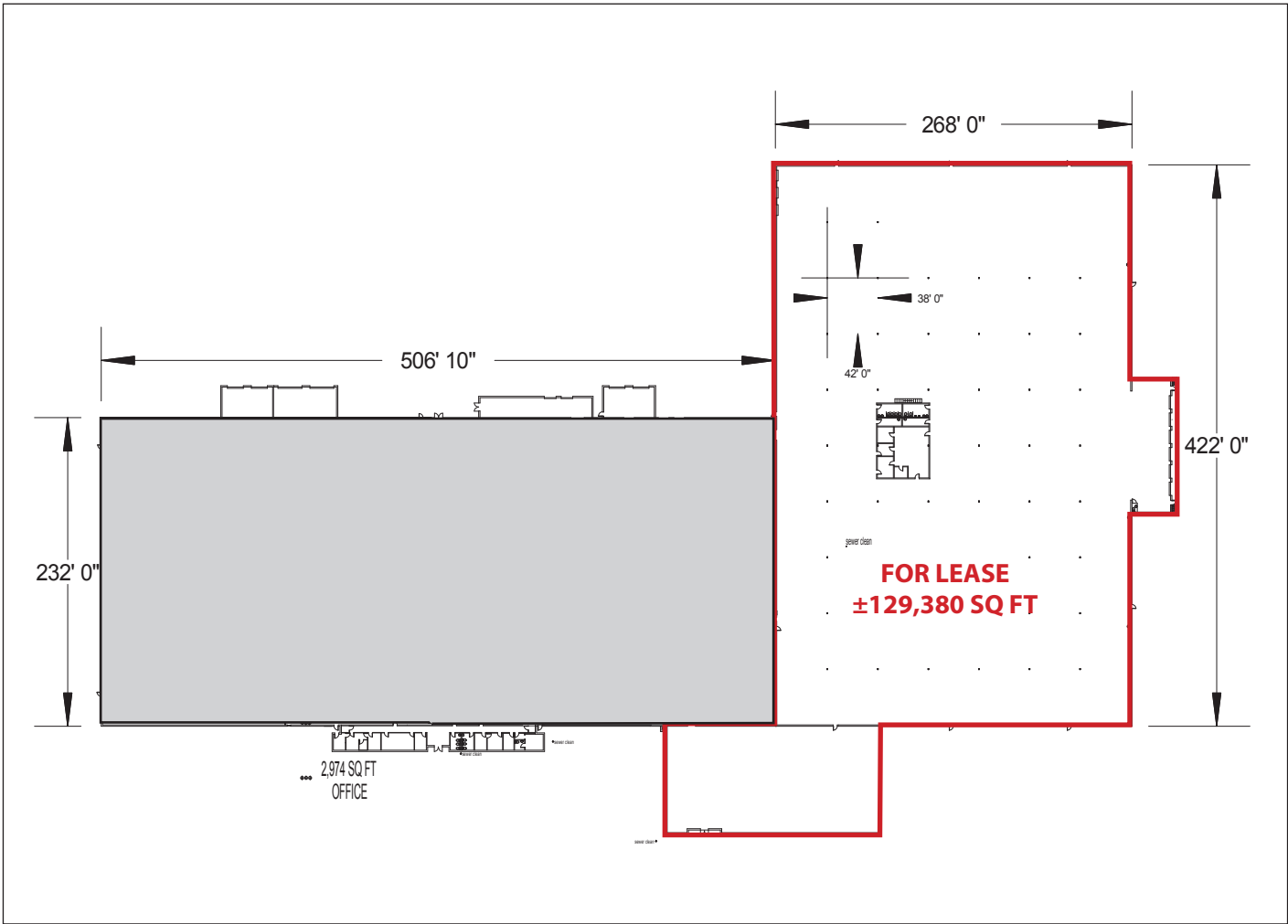

Drew C. Addison, SIOR

daddison@ipgproperties.com

678.316.2409 (cell)

770.536.6555 x 232 (office)

Floyd H. Baldwin, SIOR

fbaldwin@ipgproperties.com

770.287.5288 (cell)

770.536.6555 x 222 (office)

Palmer H. Loggins

ploggins@ipgproperties.com

770.561.3751 (cell)

770.536.6555 x 234 (office)



LOCATION

200 Cherry Hill Road, Monroe, GA 30656

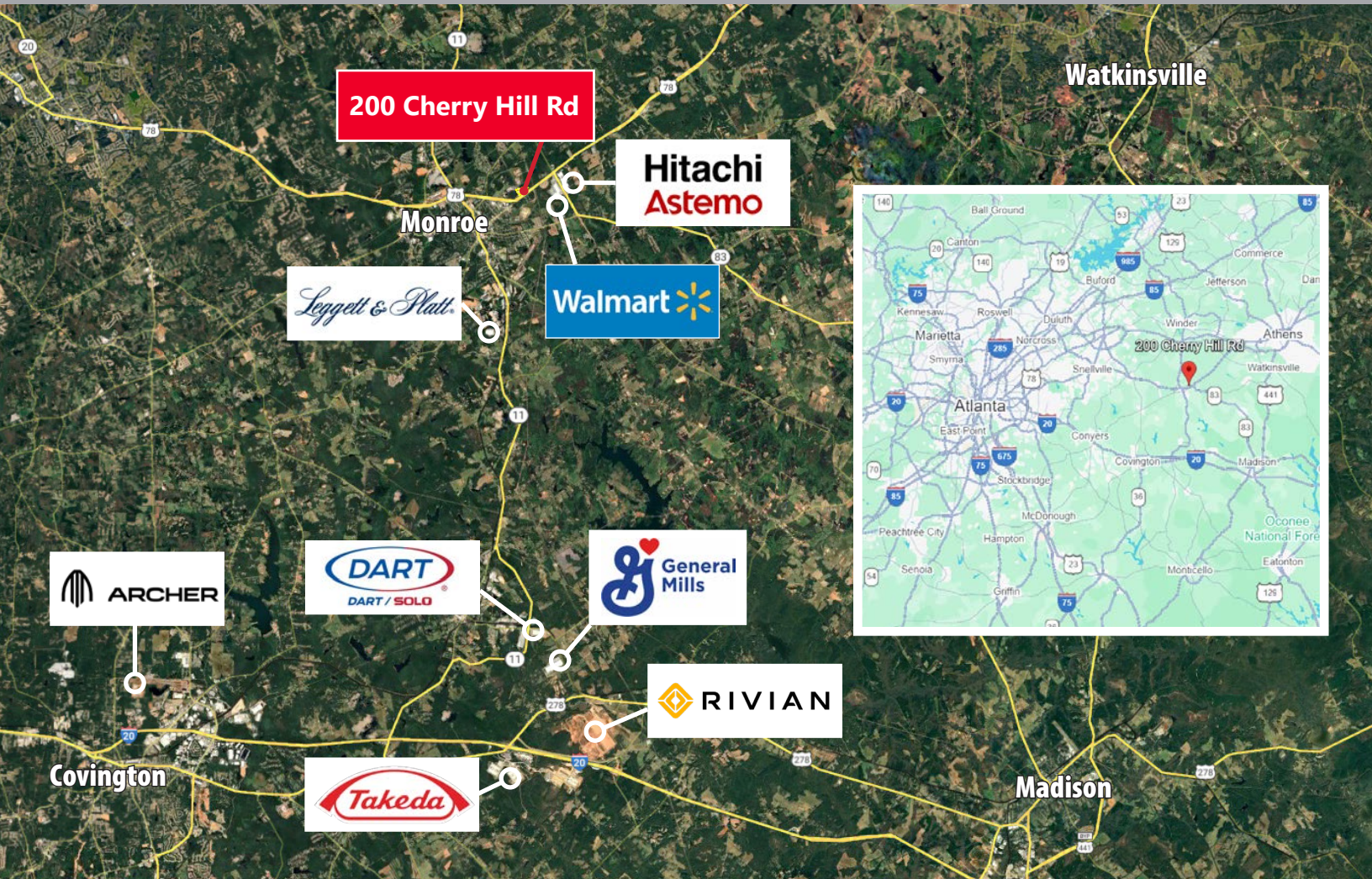

DISTANCES:

Hwy 78:	±0.2 miles	Downtown Atlanta:	±43 miles
Hwy 129:	±11 miles	Rivian Plant:	±22 miles
I-20:	±18 miles	Hartsfield Jackson Int'l Airport:	±53 miles
I-85 N:	±24 miles	Blue Ridge Connector:	±50 miles
I-285 E:	±33 miles	Port of Savannah:	±230 miles
I-75 S:	±55 miles	Greenville, SC:	±118 miles

Drew C. Addison, SIOR
 daddison@ipgproperties.com
 678.316.2409 (cell)
 770.536.6555 x 232 (office)

Floyd H. Baldwin, SIOR
 fbaldwin@ipgproperties.com
 770.287.5288 (cell)
 770.536.6555 x 222 (office)

Palmer H. Loggins
 ploggins@ipgproperties.com
 770.561.3751 (cell)
 770.536.6555 x 234 (office)

